

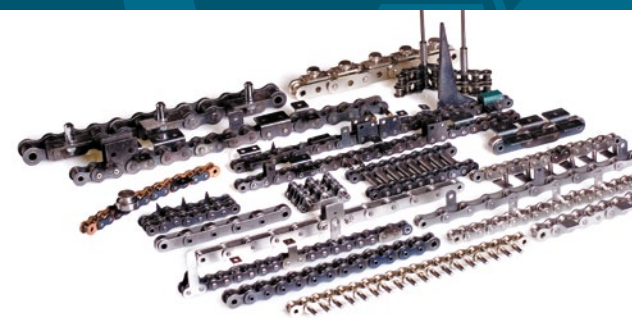

TRANSMISSION CHAINS

DIN 8187
DIN 8188





Linking you to EXCELLENCE since 1926

JOHN KING

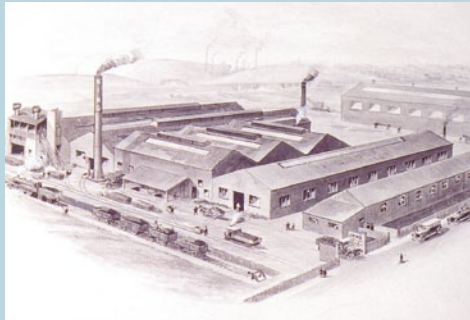

JOHN KING & COMPANY



Climax Works 1930's



Chain Assembly 1960's



New Climax Works 2000's

Company History and Qualifications

The John King Company was established in Leeds, England in 1926. Early success was achieved in the manufacture of mechanical handling equipment for the rapid mechanisation of the coal industry. In these early days conveyor chain was generally of cast link construction. The Company therefore has unrivalled experience in the production of highest quality cast link chains in ductile irons and steel under the "Climax Quality Brand". JOHN KING are undoubtedly the world leaders in this range of conveying chains.

Although cast link chains remain an important part of the JOHN KING programme, the company has progressively expanded the product range to encompass chains of other constructions and manufacturing techniques including Welded steel chains, engineered steel chains, forged fork link chains and Engineering plastic chains. Today JOHN KING offer the widest range of conveyor chains of any manufacturer which makes them unique in being able to offer an infinite number of chain types in a variety of materials and constructions for a multiplicity of industry mechanical handling applications.

In recent years it has been JOHN KING's strategy to develop the Company into a global business. This has seen the establishment, in addition to the United Kingdom, of a chain production plant in the US. John King USA Inc from their plant in East Peoria (IL) are well equipped with the manufacturing equipment for component production and assembly processes for high quality chain production serving North and South America. To provide best service in export markets the companies has warehousing and distribution worldwide and maintain ambition plans to expand the network further in the future.

All products are manufactured within the dictates of the Company's quality management according to ISO 9000 establishing consistent and high quality products and ensuring performance reliability and extended service life.

CONTENTS

British Standard Roller Chains **03** | British Standard Hollow Pin Roller Chains **04** | British Standard Roller Chains with Straight Side Plates **05** | British Standard Nickel Plated Roller Chains **06** | British Standard Stainless Steel Roller Chains **06** | British Standard A1 & K1 Attachments Roller Chains **07** | British Standard WA-1, WA-2 & WK-1, WK-2 Attachments Roller Chains **07** | British Standard SA-1 & SK-1 Attachments Roller Chains **08** | British Standard WSA-1, WSA-2 & WSK-1, WSK-2 Attachments Roller Chains **08** | British Standard Sharp Top Chains **09** | American Standard Roller Chains **10** | American Standard Heavy Steel Roller Chains **11** | American Standard Double Pitch Conveyor Chains – ISO1275 ANSI B29.3 **11** | American Standard Hollow Pin Chains **12** | American Standard Stainless Steel Roller Chains **12** | American Standard A1 & K1 Attachments Roller Chains **13** | American Standard WA-1, WA-2 & WK-1, WK-2 Attachments Roller Chains **13** | American Standard SA-1 & SK-1 Attachments Roller Chains **14** | American Standard WSA-1, WSA-2 & WSK-1, WSK-2 Attachments Roller Chains **14** | American Standard Sharp Top Chains **15** | Drive Chains – B29.15 **17** | John King Excel High Duty Drive Chain **18** | Roller Chain Pin Extractor **19** | Chain Wear Gauge **19**

British Standard Roller Chains

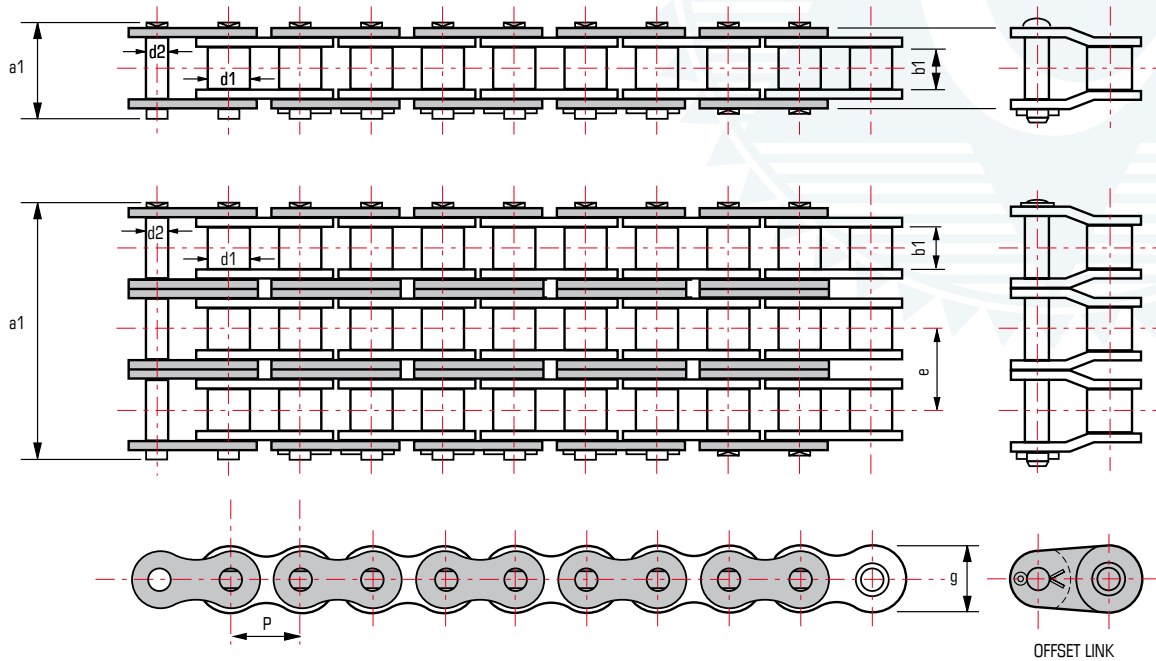

OFFSET LINK

British Standard Roller Chains

Chain Number	Pitch P	Roller		Pin Diameter d2	Side Plates Height g	Over-All Pin & Cotter a1	Transverse pitch e	Weight Kg/m	Tensile Strength N
		Width b1	Diameter d1						
	mm								
04B-1	6.00	2.80	4.00	1.85	5.00	10.30	-	0.12	3,000
05B-1	8.00	3.00	5.00	2.31	7.10	11.70	-	0.10	5,000
06B-1*	9.53	5.72	6.35	3.26	8.26	16.78	-	0.45	8,940
06B-2*	9.53	5.72	6.35	3.26	8.26	27.10	10.24	0.80	16,946
06B-3*	9.53	5.72	6.35	3.26	8.26	37.31	10.24	1.18	24,908
08B-1	12.70	7.75	8.51	4.45	11.80	20.90	-	0.68	17,836
08B-2	12.70	7.75	8.51	4.45	11.80	34.90	16.59	1.31	31,180
08B-3	12.70	7.75	8.51	4.45	11.80	47.80	16.59	1.94	44,524
81-1	12.70	3.30	7.75	3.64	9.91	11.70	-	0.28	8,000
83-1	12.70	4.88	7.75	3.64	9.91	13.10	-	0.38	8,000
10B-1	15.87	9.65	10.20	5.08	14.70	23.70	-	0.95	22,240
10B-2	15.87	9.65	10.20	5.08	14.70	40.30	16.60	1.87	44,524
10B-3	15.87	9.65	10.20	5.08	14.70	56.90	16.60	2.80	66,764
12B-1	19.05	11.68	12.07	5.72	16.10	27.31	-	1.19	28,912
12B-2	19.05	11.68	12.07	5.72	16.10	46.31	19.50	2.34	57,868
12B-3	19.05	11.68	12.07	5.72	16.10	66.29	19.50	3.47	86,780
16B-1	25.40	17.02	15.88	8.28	21.10	41.50	-	2.72	56,889
16B-2	25.40	17.02	15.88	8.28	21.10	73.41	31.88	5.37	113,735
16B-3	25.40	17.02	15.88	8.28	21.10	105.30	31.88	8.02	170,625

* Bush chain

Transmission Chains

DIN8187

British Standard Roller Chains

Chain Number	Pitch	Roller		Pin Diameter	Side Plates Height	Over-All Pin & Cotter	Transverse pitch	Weight	Tensile Strength
		Width	Diameter						
	P	b1	d1	d2	g	a1	e	Kg/m	N
20B-1	31.75	19.56	19.05	10.19	26.42	49.30	–	3.88	93,141
20B-2	31.75	19.56	19.05	10.19	26.42	85.80	36.45	7.66	176,496
20B-3	31.75	19.56	19.05	10.19	26.42	122.20	36.45	11.44	264,744
24B-1	38.10	25.40	25.40	14.60	33.40	59.99	–	6.85	166,711
24B-2	38.10	25.40	25.40	14.60	33.40	108.40	48.36	13.87	317,721
24B-3	38.10	25.40	25.40	14.60	33.40	156.80	48.36	20.89	475,580
28B-1	44.45	30.99	27.94	15.90	37.00	65.10	–	8.56	200,000
28B-2	44.45	30.99	27.94	15.90	37.00	124.70	59.56	16.96	360,000
28B-3	44.45	30.99	27.94	15.90	37.00	184.30	59.56	25.38	536,000
32B-1	50.80	30.99	29.21	17.80	42.20	67.40	–	9.49	250,000
32B-2	50.80	30.99	29.21	17.80	42.20	126.00	58.55	18.74	443,896
32B-3	50.80	30.99	29.21	17.80	42.20	184.50	58.55	28.04	670,000
40B-1	63.50	38.10	39.37	22.89	52.90	92.50	–	15.53	352,299
40B-2	63.50	38.10	39.37	22.89	52.90	151.21	72.29	30.72	630,000
40B-3	63.50	38.10	39.37	22.89	52.90	223.80	72.29	45.97	950,000
48B-1	76.20	45.72	48.26	29.24	64.00	98.88	–	24.45	560,000
48B-2	76.20	45.72	48.26	29.24	64.00	200.00	91.21	48.54	1,096,041
48B-3	76.20	45.72	48.26	29.24	64.00	291.00	91.21	72.67	1,500,000

British Standard Hollow Pin Roller Chains

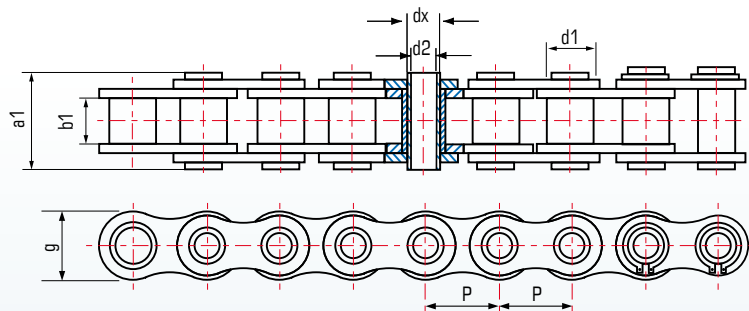

British Standard Hollow Pin Roller Chains

Chain Number	Pitch	Roller		Pin		Side Plates Height	Over-All Pin & Cotter	Weight	Tensile Strength
		Width	Diameter	Diameter	Inner Diameter				
	P	b1	d1	d2	dx	g	a1	Kg/m	N
08BHP	12.70	7.75	8.51	6.28	4.50	11.80	20.90	0.70	10,790
10BHP	15.88	9.65	10.16	7.02	5.18	14.70	23.70	0.92	14,710
12BHP	19.05	11.68	12.07	8.09	5.00	16.10	27.31	1.19	22,600

British Standard Roller Chains with Straight Side Plates

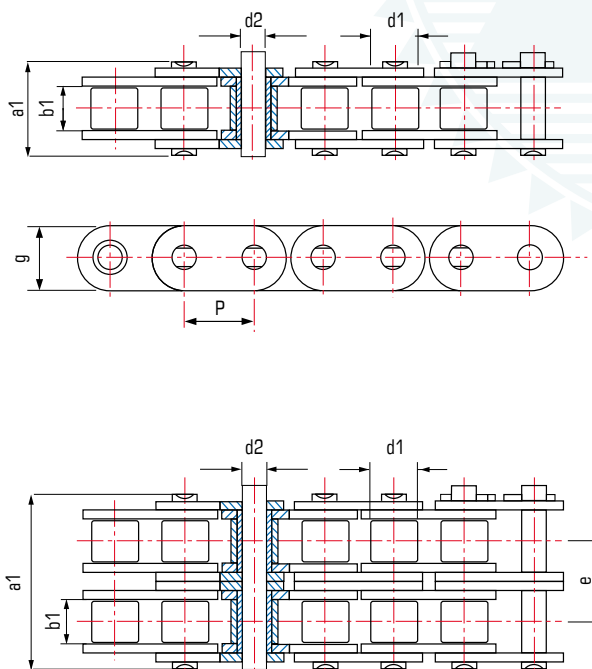

British Standard Roller Chains with Straight Side Plates

Chain Number	Pitch	Roller		Pin Diameter	Side Plates Height	Over-All Pin & Cotter	Transverse pitch	Weight	Tensile Strength
		Width	Diameter						
	p	b1	d1	d2	g	a1	e	Kg/m	N
06B-1*	9.53	5.72	6.35	3.26	8.26	16.78	–	0.45	8,940
06B-2*	9.53	5.72	6.35	3.26	8.26	27.10	10.24	0.80	16,946
06B-3*	9.53	5.72	6.35	3.26	8.26	37.31	10.24	1.18	24,908
08B-1	12.70	7.75	8.51	4.45	11.80	20.90	–	0.74	17,836
08B-2	12.70	7.75	8.51	4.45	11.80	34.90	13.92	1.41	31,180
08B-3	12.70	7.75	8.51	4.45	11.80	47.80	13.92	2.08	44,524
10B-1	15.85	9.65	10.16	5.08	14.70	23.70	–	0.95	22,240
10B-2	15.85	9.65	10.16	5.08	14.70	46.81	16.60	1.97	44,524
10B-3	15.85	9.65	10.16	5.08	14.70	66.29	16.60	2.80	66,764
12B-1	19.05	11.68	12.07	5.72	16.10	27.31	–	1.19	28,912
12B-2	19.05	11.68	12.07	5.72	16.10	46.31	19.50	2.34	57,868
16B-1	25.40	17.02	15.88	8.28	21.10	41.50	–	3.30	60,889

* Bush chain

Transmission Chains

DIN8187

British Standard Nickel Plated Roller Chains

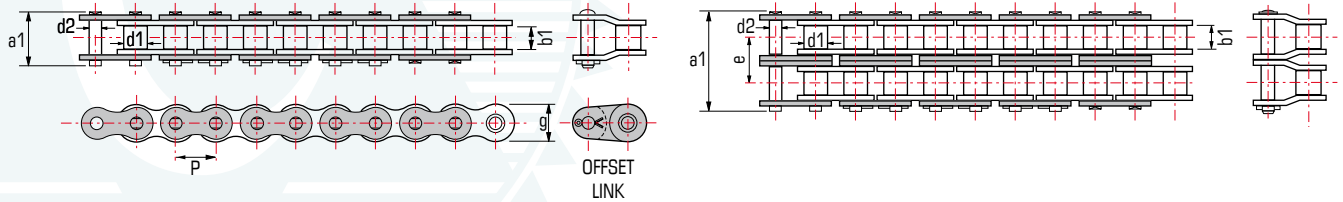

British Standard Nickel Plated Roller Chains

Chain Number	Pitch	Roller		Pin Diameter	Side Plates Height	Over-All Pin & Cotter	Transverse pitch	Weight	Tensile Strength
		Width	Diameter						
	P	b1	d1	d2	g	a1	e	Kg/m	N
06B-1 NP*	9.53	5.72	6.35	3.26	8.26	16.78	-	0.45	8,940
08B-1 NP	12.7	7.75	8.51	4.45	11.8	20.9	-	0.74	17,836
10B-1 NP	15.85	9.65	10.16	5.08	14.7	23.7	-	0.95	22,240
12B-1 NP	19.05	11.68	12.07	5.72	16.1	27.31	-	1.19	28,912
12B-2 NP	19.05	11.68	12.07	5.72	16.1	46.31	19.46	2.34	57,868
16B-1 NP	25.4	17.02	15.88	8.27	21.1	41.5	-	2.72	56,889

* Bush chain

British Standard Stainless Steel Roller Chains

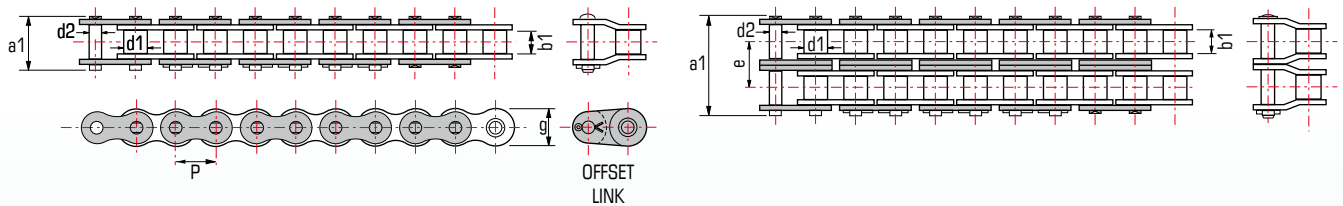

British Standard Stainless Steel Roller Chains

Chain Number	Pitch	Roller		Pin Diameter	Side Plates Height	Over-All Pin & Cotter	Transverse pitch	Weight	Tensile Strength
		Width	Diameter						
	P	b1	d1	d2	g	a1	e	Kg/m	N
06B-1SS*	9.53	5.72	6.35	3.28	8.20	16.80	-	0.44	6,650
06B-2SS*	9.53	5.72	6.35	3.28	8.20	27.10	10.24	0.74	10,500
08B-1SS	12.70	7.75	8.51	4.45	11.80	20.90	-	0.70	12,000
08B-2SS	12.70	7.75	8.51	4.45	11.80	34.90	13.92	1.40	22,000
10B-1SS	15.88	9.65	10.16	5.08	14.70	23.70	-	0.92	15,000
10B-2SS	15.88	9.65	10.16	5.08	14.70	40.30	16.59	3.00	28,450
12B-1SS	19.05	11.68	12.07	5.72	16.10	27.30	-	1.12	17,000
12B-2SS	19.05	11.68	12.07	5.72	16.10	46.80	19.46	2.21	37,250
16B-1SS	25.40	17.02	15.88	8.27	21.00	41.50	-	2.59	40,000
16B-2SS	25.40	17.02	15.88	8.27	21.00	73.40	31.88	5.08	74,450

* Bush chain

British Standard A1 & K1 Attachments Roller Chains

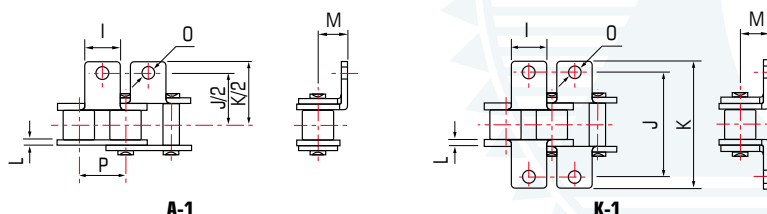

British Standard A1 & K1 Attachments Roller Chains

Chain Number	Pitch	I	J	K	L	M	O
	P						
mm							
06B*	9.525	8.00	19.04	27.00	1.30	6.50	3.50
08B	12.700	9.50	25.40	36.40	1.60	8.90	4.50
10B	15.875	14.30	31.75	44.60	1.70	10.31	5.30
12B	19.050	16.00	38.10	52.40	1.85	13.46	6.40
16B	25.400	19.10	50.80	72.60	3.10	15.88	6.40

Note: check attachment dimensions before ordering since manufacturing standards may vary
* Bush chain

British Standard WA-1, WA-2 & WK-1, WK-2 Attachments Roller Chains

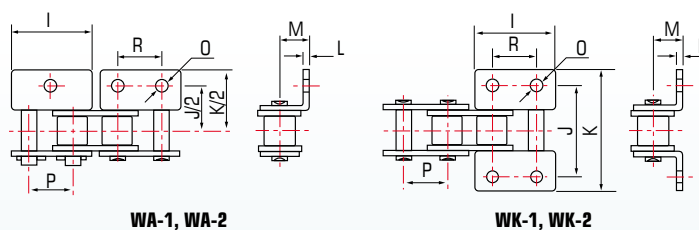

British Standard WA-1; WA2 & WK-1; WK-2 Attachments Roller Chains

Chain Number	Pitch	I	R	J	K	L	M	O
	P							
mm								
08B	12.700	24.00	12.70	25.40	36.40	1.60	8.90	4.30
10B	15.875	29.58	15.88	31.80	44.60	1.70	10.31	5.30
12B	19.050	34.05	19.05	38.10	52.40	1.85	13.46	6.40
16B	25.400	46.40	25.40	50.80	72.60	3.10	15.88	6.40

Note: check attachment dimensions before ordering since manufacturing standards may vary

British Standard SA-1 & SK-1 Attachments Roller Chains

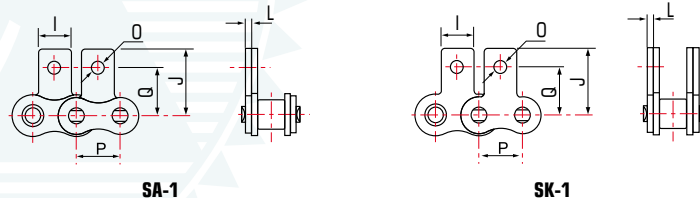

British Standard SA-1 & SK-1 Attachments Roller Chains

Chain Number	Pitch	I	Q	J	L	O
	P					
mm						
06B*	9.525	8.00	9.52	13.50	1.30	3.50
08B	12.700	9.50	13.35	18.90	1.60	4.30
10B	15.875	14.30	16.50	22.95	1.70	5.30
12B	19.050	16.00	21.45	28.60	1.85	6.40
16B	25.400	19.10	23.15	34.00	3.10	6.40

Note: check attachment dimensions before ordering since manufacturing standards may vary
* Bush chain

British Standard WSA-1, WSA-2 & WSK-1, WSK-2 Attachments Roller Chains

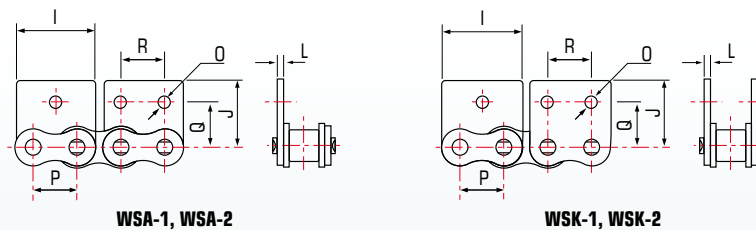

British Standard WSA-1; WSA2 & WSK-1; WSK-2 Attachments Roller Chains

Chain Number	Pitch	I	R	Q	J	L	O
	P						
mm							
08B	12.700	23.30	12.70	13.35	18.90	1.60	4.30
10B	15.875	29.58	15.88	16.50	22.95	1.70	5.30
12B	19.050	34.05	19.05	21.45	28.60	1.85	6.40
16B	25.400	46.40	25.40	23.15	34.00	3.10	6.40

Note: check attachment dimensions before ordering since manufacturing standards may vary

British Standard Sharp Top Chains

(5 PEP) Series

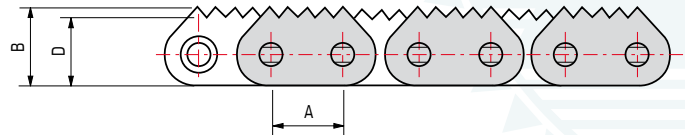

British Standard Sharp Top Chains (5 PEP) Series

Chain Number	A	B	D
	mm		
12B-1	19.05	21.10	12.35
12B-2	19.05	21.10	12.35
16B-1	25.40	26.50	21.10
16B-2	25.40	26.50	21.10
20B-1	31.80	32.80	26.42
20B-2	31.80	32.80	26.42
24B-1	38.10	38.50	33.40
24B-2	38.10	38.50	33.40

32B-1 (2PEP)

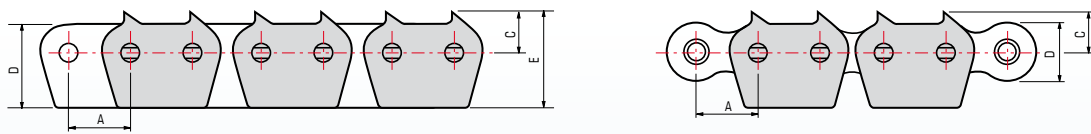

STYLE 1

STYLE 2

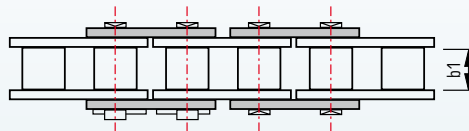

British Standard Sharp Top Chains 32B-1 (2PEP)

Chain Number	b1	A	C	D (STYLE 1)	D (STYLE 2)	E
	mm					
32B-1 Narrow	17.02	50.80	30.00	64.00	41.00	73.00
32B-1 Standard	30.99	50.80	30.00	64.00	41.00	73.00

Transmission Chains

DIN8188

American Standard Roller Chains

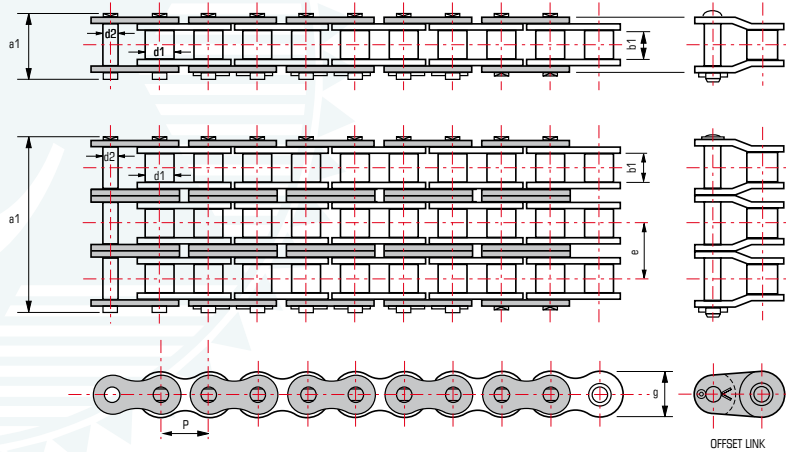

American Standard Roller Chains

Chain Number	Pitch P	Roller		Pin Diameter d2	Side Plates Height g	Over-All Pin & Cotter a1	Transverse pitch e	Weight	Tensile Strength
		Width b1	Diameter d1						
									inches
									Kg/m
									N
25-1*	0.250	0.125	0.130	0.090	0.236	0.370	-	0.13	3,892
25-2*	0.250	0.125	0.130	0.090	0.236	0.630	0.252	0.24	7,784
35-1*	0.375	0.188	0.200	0.141	0.354	0.560	-	0.31	9,341
35-2*	0.375	0.188	0.200	0.141	0.354	0.960	0.399	0.67	18,683
35-3*	0.375	0.188	0.200	0.141	0.354	1.360	0.399	1.01	28,024
40-1	0.500	0.313	0.312	0.156	0.472	0.720	-	0.61	17,792
40-2	0.500	0.313	0.312	0.156	0.472	1.290	0.566	1.19	35,584
40-3	0.500	0.313	0.312	0.156	0.472	1.850	0.566	1.79	56,376
41-1	0.500	0.250	0.306	0.141	0.390	0.650	-	0.39	10,675
50-1	0.625	0.375	0.400	0.200	0.594	0.890	-	1.01	29,356
50-2	0.625	0.375	0.400	0.200	0.594	1.600	0.713	1.96	58,713
50-3	0.625	0.375	0.400	0.200	0.594	2.310	0.713	2.95	88,070
50-4	0.625	0.375	0.400	0.200	0.594	3.030	0.713	3.93	117,427
60-1	0.750	0.500	0.469	0.234	0.709	1.110	-	1.47	37,808
60-2	0.750	0.500	0.469	0.234	0.709	2.010	0.897	2.9	75,616
60-3	0.750	0.500	0.469	0.234	0.709	2.910	0.897	4.29	113,424
60-4	0.750	0.500	0.469	0.234	0.709	3.810	0.897	5.8	151,232
80-1	1.000	0.625	0.625	0.312	0.945	1.440	-	2.57	64,446
80-2	1.000	0.625	0.625	0.312	0.945	2.590	1.153	5.04	128,992
80-3	1.000	0.625	0.625	0.312	0.945	3.740	1.153	7.47	193,488
100-1	1.250	0.750	0.750	0.375	1.181	1.730	-	3.73	106,752
100-2	1.250	0.750	0.750	0.375	1.181	3.140	1.408	7.31	213,504
100-3	1.250	0.750	0.750	0.375	1.181	4.560	1.408	11.01	320,256
120-1	1.500	1.000	0.875	0.437	1.406	2.140	-	5.49	151,232
120-2	1.500	1.000	0.875	0.437	1.406	3.930	1.789	10.94	302,464
120-3	1.500	1.000	0.875	0.437	1.406	5.720	1.789	16.52	453,696
140-1	1.750	1.000	1.000	0.500	1.663	2.310	-	7.450	172,400
140-2	1.750	1.000	1.000	0.500	1.663	4.240	1.924	14.390	344,800
140-3	1.750	1.000	1.000	0.500	1.663	6.160	1.924	21.320	517,200
160-1	2.000	1.250	1.125	0.562	1.899	2.730	-	9.740	226,800
160-2	2.000	1.250	1.125	0.562	1.899	5.040	2.305	19.120	453,600
160-3	2.000	1.250	1.125	0.562	1.899	7.350	2.305	28.370	680,400
180-1	2.250	1.406	1.406	0.687	2.132	3.150	-	13.510	280,200
180-2	2.250	1.406	1.406	0.687	2.132	5.750	2.592	26.340	560,500
200-1	2.500	1.500	1.562	0.781	2.312	3.440	-	15.880	353,800
200-2	2.500	1.500	1.562	0.781	2.312	6.260	2.817	32.050	707,600

* Bush chain

American Standard Heavy Steel Roller Chains

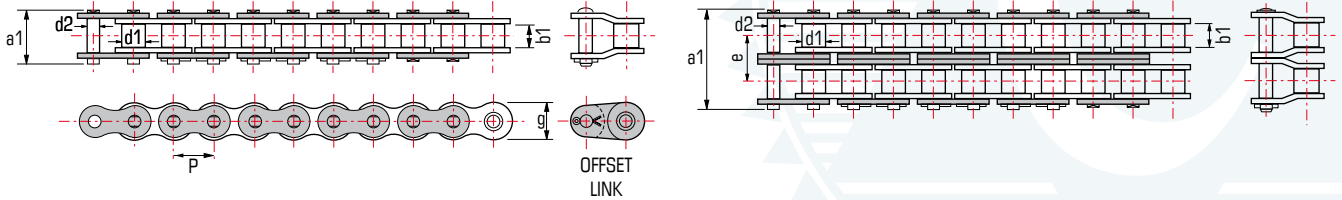

American Standard Heavy Steel Roller Chains

Chain Number	Pitch	Roller		Pin Diameter	Side Plate Height	Over-All Pin & Cotter	Transverse pitch	Weight	Tensile Strength
		Width	Diameter						
	P	b1	d1	d2	g	a1	e	Kg/m	N
inches									
60H-1	0.750	0.500	0.469	0.234	0.709	1.240	-	1.18	8,500
60H-2	0.750	0.500	0.469	0.234	0.709	2.270	1.028	2.33	17,000
80H-1	1.000	0.625	0.625	0.312	0.945	1.570	-	2.05	14,500
80H-2	1.000	0.625	0.625	0.312	0.945	2.840	1.283	3.93	29,000
100H-1	1.250	0.750	0.750	0.375	1.181	1.860	-	2.82	24,000
100H-2	1.250	0.750	0.750	0.375	1.181	3.410	1.539	5.58	48,000

American Standard Double Pitch Conveyor Chains – ISO1275 ANSI B29.3

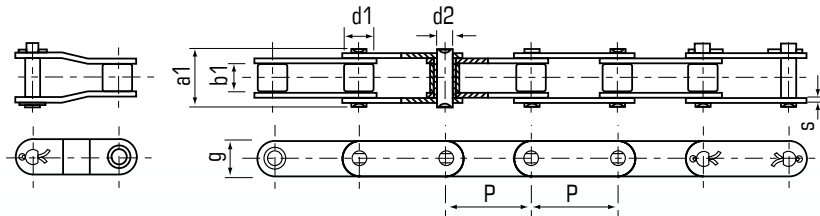

American Standard Double Pitch Conveyor Chains

Chain Number	Pitch	Roller		Pin Diameter	Over-All Pin & Cotter	Side Plates Height	Plate Thickness	Weight	Tensile Strength
		Width	Diameter						
	P	b1	d1	d2	a1	g	s	Kg/m	N
inches									
C2040	1.000	0.309	0.313	0.156	0.701	0.472	0.059	0.50	16,700
C2042	1.000	0.309	0.625	0.156	0.701	0.472	0.059	0.84	16,700
C2040H	1.000	0.309	0.313	0.156	0.783	0.472	0.080	0.65	17,200
C2050	1.250	0.370	0.400	0.200	0.874	0.591	0.080	0.78	28,100
C2052	1.250	0.370	0.750	0.200	0.874	0.591	0.080	1.27	28,100
C2060	1.500	0.495	0.469	0.234	1.091	0.709	0.095	1.12	36,800
C2062	1.500	0.495	0.875	0.234	1.091	1.709	0.095	1.61	36,800
C2060H	1.500	0.495	0.469	0.234	1.244	0.709	0.128	1.44	41,600
C2062H	1.500	0.495	0.875	0.234	1.244	0.709	0.128	2.07	41,600
C2080	2.000	0.620	0.625	0.312	1.437	0.945	0.128	2.08	65,700
C2082	2.000	0.620	1.125	0.312	1.437	0.945	0.128	3.12	65,700
C2080H	2.000	0.620	0.625	0.312	1.551	0.961	0.157	2.54	70,000
C2082H	2.000	0.620	1.125	0.312	1.551	0.961	0.157	3.58	70,000

American Standard Hollow Pin Chains

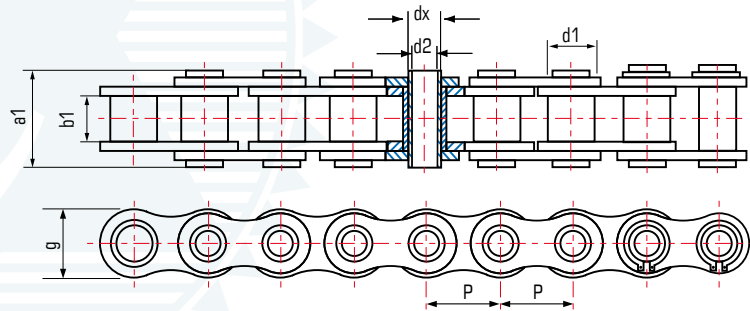

American Standard Hollow Pin Chains

Chain Number	Pitch	Roller		Pin		Side Plates Height	Over-All Pin & Cotter	Weight	Tensile Strength
		Width	Diameter	Inner Diameter	Outer Diameter				
	P	b_1	d_1	d_2	d_x	g	a_1	Kg/m	N
	inches								
40HP	0.500	0.313	0.312	0.156	0.177	0.500	0.720	0.61	17,792
50HP	0.625	0.375	0.400	0.200	0.204	0.625	0.890	1.01	29,356
60HP	0.750	0.500	0.469	0.234	0.230	0.688	1.110	1.47	37,808
80HP	1.000	0.625	0.625	0.312	0.328	1.000	1.440	2.57	64,446

American Standard Stainless Steel Roller Chains

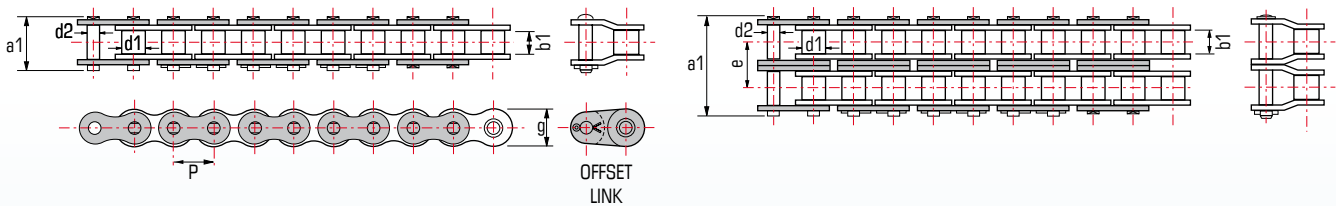

American Standard Stainless Steel Roller Chains

Chain Number	Pitch	Roller		Pin	Side Plates Height	Over-All Pin & Cotter	Transverse pitch	Weight	Tensile Strength
		Width	Diameter	Diameter					
	P	b_1	d_1	d_2	g	a_1	e	Kg/m	N
	inches								
35-1SS*	0.375	0.188	0.200	0.141	0.354	0.560	-	0.21	1,700
40-1SS	0.500	0.313	0.312	0.156	0.472	0.720	-	0.41	3,000
40-2SS	0.500	0.313	0.312	0.156	0.472	1.290	0.566	0.80	6,000
41-1SS	0.500	0.250	0.306	0.141	0.390	0.650	-	0.28	1,700
50-1SS	0.625	0.375	0.400	0.200	0.594	0.890	-	0.68	4,700
50-2SS	0.625	0.375	0.400	0.200	0.594	1.600	0.713	1.31	9,500
60-1SS	0.750	0.500	0.469	0.234	0.709	1.110	-	1.00	6,700
60-2SS	0.750	0.500	0.469	0.234	0.709	2.010	0.897	1.94	13,600
80-1SS	1.000	0.625	0.625	0.312	0.945	1.440	-	1.73	12,000

* Bush chain

American Standard A1 & K1 Attachments Roller Chains

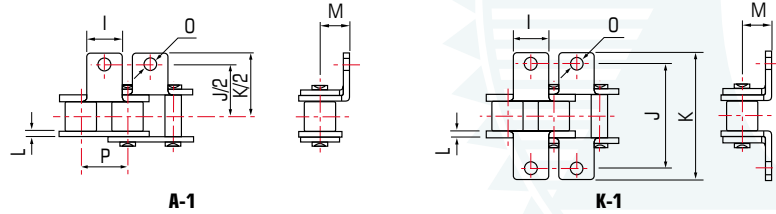

American Standard A1 & K1 Attachments Roller Chains

Chain Number	Pitch	I	J	K	L	M	O
	P						
inches							
40	0.500	0.374	1.000	1.386	0.059	0.311	0.134
50	0.625	0.500	1.250	1.819	0.080	0.406	0.217
60	0.750	0.626	1.500	2.189	0.095	0.469	0.217
80	1.000	0.752	2.000	2.551	0.128	0.626	0.268
100	1.250	1.000	2.500	3.437	0.157	0.780	0.362
120	1.500	1.126	3.000	4.272	0.189	0.906	0.386
140	1.750	1.374	3.500	4.843	0.220	1.126	0.449
160	2.000	1.500	4.000	5.622	0.252	1.252	0.516

Note: check attachment dimensions before ordering since manufacturing standards may vary

American Standard WA-1, WA-2 & WK-1, WK-2 Attachments Roller Chains

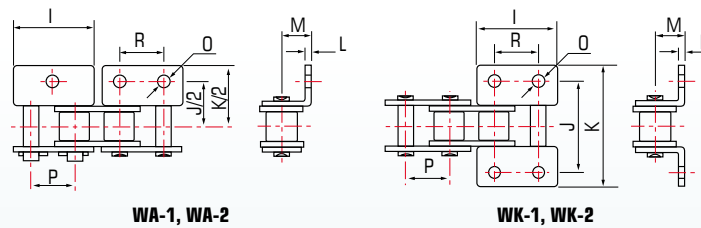

American Standard WA-1; WA2 & WK-1; WK-2 Attachments Roller Chains

Chain Number	Pitch	I	R	J	K	L	M	O
	P							
inches								
40	0.500	0.906	0.500	1.000	1.402	0.059	0.311	0.134
50	0.625	1.134	0.625	1.252	1.843	0.080	0.406	0.217
60	0.750	1.364	0.750	1.500	2.220	0.095	0.469	0.217
80	1.000	1.807	1.000	2.000	2.882	0.128	0.626	0.268
100	1.250	2.270	1.250	2.500	3.535	0.157	0.780	0.362

Note: check attachment dimensions before ordering since manufacturing standards may vary

American Standard SA-1 & SK-1 Attachments Roller Chains

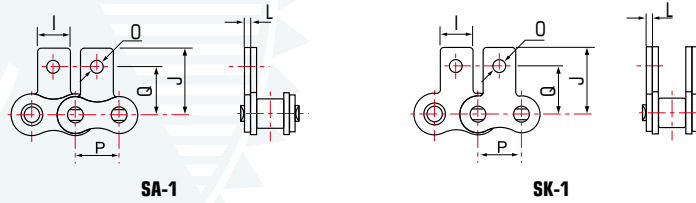

American Standard SA1 & SK1 Attachments Roller Chains

Chain Number	Pitch	I	Q	J	L	O
	P					
inches						
40	0.500	0.374	0.500	0.750	0.059	0.134
50	0.625	0.500	0.626	0.994	0.080	0.217
60	0.750	0.626	0.720	1.155	0.095	0.217
80	1.000	0.752	0.969	1.366	0.128	0.268
100	1.250	1.000	1.252	1.705	0.157	0.362
120	1.500	1.126	1.437	2.031	0.189	0.386
140	1.750	1.374	1.752	2.441	0.220	0.449
160	2.000	1.500	2.000	2.750	0.252	0.516

Note: check attachment dimensions before ordering since manufacturing standards may vary

American Standard WSA-1, WSA-2 & WSK-1, WSK-2 Attachments Roller Chains

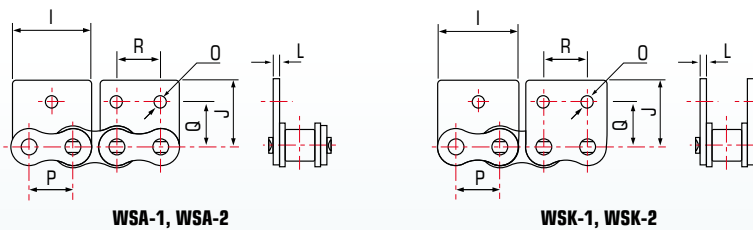

American Standard WSA-1; WSA2 & WSK-1; WSK-2 Attachments Roller Chains

Chain Number	Pitch	I	R	Q	J	L	O
	P						
inches							
40	0.500	0.906	0.500	0.500	0.685	0.059	0.134
50	0.625	1.134	0.625	0.626	0.907	0.080	0.217
60	0.750	1.364	0.750	0.720	1.057	0.095	0.217
80	1.000	1.807	1.000	0.969	1.396	0.128	0.268
100	1.250	2.270	1.250	1.252	1.732	0.157	0.362

Note: check attachment dimensions before ordering since manufacturing standards may vary

American Standard Sharp Top Chains

3-Point (ST) Series

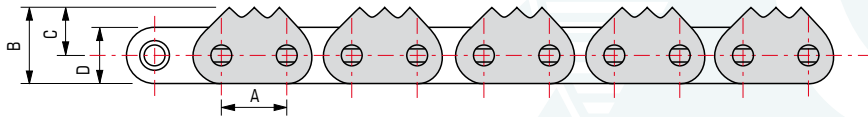

4 PEP – (4 Point Every Pitch)

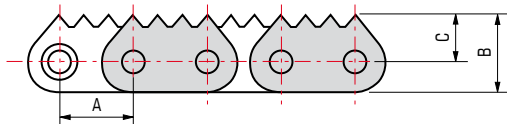

5 PEP Series – (5 Point Every Pitch)

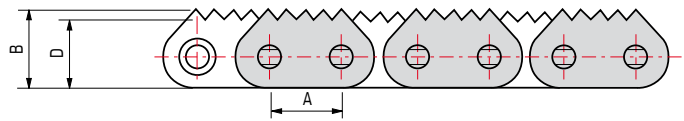

160-1-DP Series

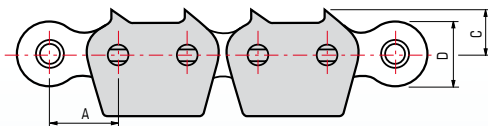

American Standard Sharp Top Chains

Chain Number	A	B	C	D
	inches			
60-1 ST	0.750	0.850	0.512	0.689
60-2 ST	0.750	0.854	0.510	0.685
80-1 ST	1.000	1.140	0.685	0.914
80-2 ST	1.000	1.043	0.630	–
80-3 ST	1.000	1.142	–	1.028
80-4 ST	1.000	1.142	–	1.028
100-1 ST	1.250	1.325	0.750	1.142
100-2 ST	1.250	1.325	0.715	1.147
100-3 ST	1.250	1.325	0.754	1.147
120-1 ST	1.500	1.594	0.909	1.370
120-2 ST	1.500	1.594	0.909	1.370
120-4 ST	1.500	1.594	0.909	1.370
160-1-DP	2.000	–	1.301	1.850

Transmission Chains



Drive Chains – B29.15

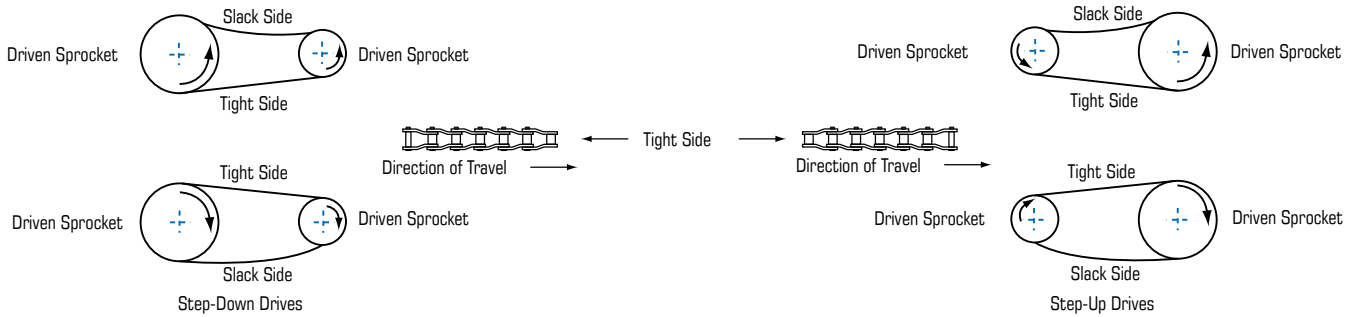
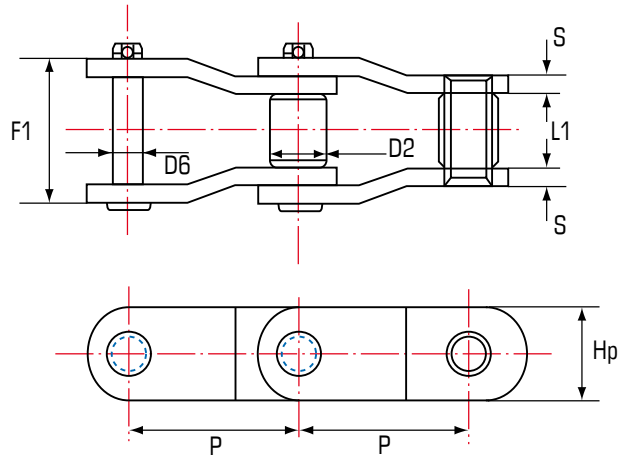

Drive Chains ANSI B29.10

Chain Number	Pitch	Inside Width	Roller Diameter	Pin	Side Plate		Over All width	BREAKING LOAD		WEIGHT
					Height	Thickness		lb	kg	
	P	L1	D2	D6	Hp	S	F1			kg/m
JK 508	50.80	31.75	28.58	15.06	40.00	8.00	79.00	65,000	29,500	11.3
JK 882	66.27	28.60	22.23	11.10	28.40	6.40	67.50	28,000	12,700	5.4
JK 3011	77.90	38.10	41.40	19.05	57.20	9.70	100.00	110,000	49,900	17.9
JK 1031	78.10	38.10	31.75	15.88	38.10	8.00	88.00	48,000	21,750	10.5
JK 3075	78.10	38.10	31.75	15.88	41.50	9.50	97.00	75,000	34,000	14.3
JK 3500	88.90	38.60	44.45	22.23	58.00	12.70	114.00	150,000	68,000	23.9
JK 4063	103.20	49.20	44.45	22.23	57.00	12.70	127.00	150,000	68,000	23.9
JK 4073	103.45	49.60	31.75	23.80	60.00	14.50	129.40	170,000	77,100	27.2
JK 4500	114.30	50.80	57.15	27.94	76.20	14.20	133.90	208,000	94,350	38.3
JK 5031	127.00	69.90	63.50	31.55	89.00	15.88	158.25	260,000	117,950	52.3
JK 1605	127.00	63.50	63.50	34.93	89.00	20.00	170.00	330,000	149,700	54.3
JK 6042	152.40	74.60	76.20	38.10	100.00	20.00	186.00	420,000	190,500	67.0



John King Excel High Duty Drive Chain

John King uniquely manufacture an uprated range of offset side bar drive chain under "Excel" this follows the standard dimensionally but has been uprated in critical areas to offer improvements in service life and operational reliability. This products is normally available to order at 4.00" pitch and above. It has performed where other manufactures have failed.

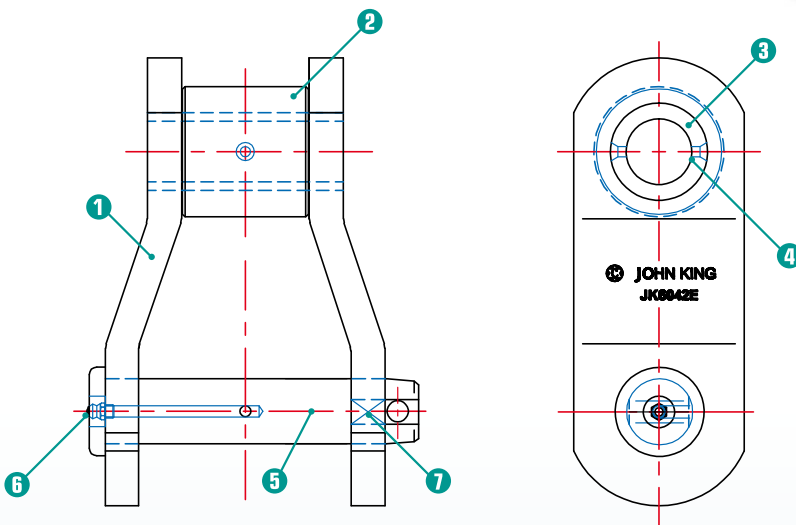

- 1 Uprated link plate material. Heated treated for maximum strength and integrity.
- 2 Optimum material and heat treatment will maintain smooth gearing performance through the service life of the chain.
- 3 Increased bush wall thickness to accommodate increased bearing pressures.
- 4 Oil hole at two points through bush to allow ingress of lubricant to bearing pin surface.
- 5 Best specification for chain bearing pin will see reliable and extended operation.
- 6 Grease facility through pin to allow introduction of lubrication into critical areas.
- 7 Anti rotation flat to provide positive mechanical retention to pin.

For extra high duty applications consider the uprated Excel standard available in sizes above JK4063. The Excel standard has proven reliability in the more difficult applications with significant extension in chain service life.

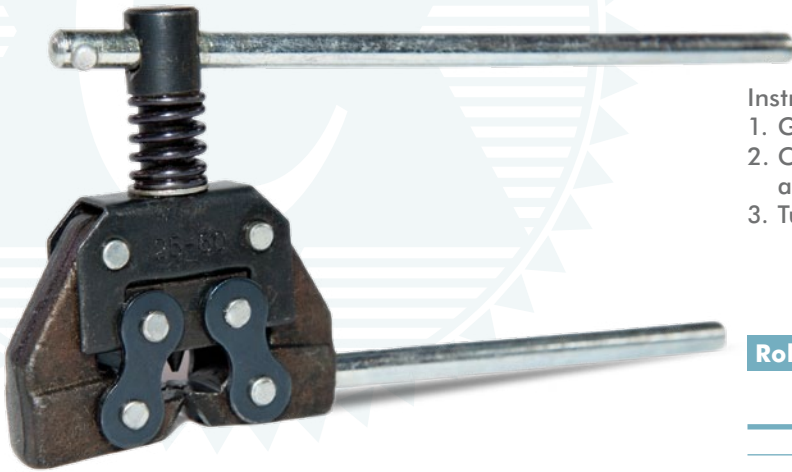

Roller Chain Pin Extractor

A tool designed to disassemble pins from roller chain.

Instructions for Application

1. Grind off rivet head
2. Clamp chain with extractor jaws inside the linkplate and over the chain roller
3. Turn extractor screw to engage with rivet and press out

Roller Chain Pin Extractor

For Chain Sizes	Model Number	Approx. Shipping Wt.
		kg
25-60	PE 113	0.363
60-100	PE 135	1.270



Chain Wear Gauge

This device offers a quick and easy means of establishing chain wear condition.

It covers 9 sizes of American and British standard transmission chains .

The GO-NO GO gauge offers an immediate and effective indication of pitch extension and therefore wear condition.



Certificate of Registration

QUALITY MANAGEMENT SYSTEM - ISO 9001:2008

This is to certify that:

John King Chains Ltd
New Climax Works
Lancaster Way
Sherburn in Elmet
Leeds
LS25 6NS
United Kingdom

Holds Certificate No: **FM 77342**

and operates a Quality Management System which complies with the requirements of ISO 9001:2008 for the following scope:

The manufacture, procurement and supply of conveying chains, sprockets and ancillary components including engineered steel, cast link, forged link and Acetal chains including related processes of machining, laser profiling, forming and general fabrication

For and on behalf of BSI:

Gary Fenton, Global Assurance Director

Originally registered: **15/11/2003**

Latest Issue: **25/05/2012**

Expiry Date: **24/07/2015**



Page: 1 of 1

This certificate was issued electronically and remains the property of BSI and is bound by the conditions of contract.
An electronic certificate can be authenticated [online](#).
Printed copies can be validated at www.bsigroup.com/ClientDirectory

Information and Contact: BSI, Kitemark Court, Davy Avenue, Knowlhill, Milton Keynes MK5 8PP. Tel: + 44 845 080 9000
BSI Assurance UK Limited, registered in England under number 7805321 at 389 Chiswick High Road, London W4 4AL, UK.
A Member of the BSI Group of Companies.





JOHN KING

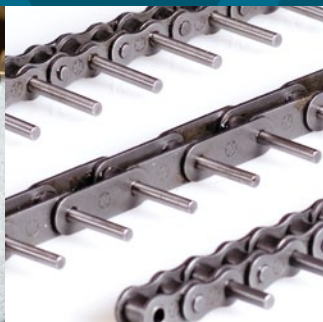

John King Chains Limited
New Climax Works,
Lancaster Business Park,
Sherburn-in-Elmet LS25 6NS UK
Tel: (44) 1977 681 910
Fax: (44) 1977 681 899
Email: general@johnkingchains.co.uk

John King Chains (SA) (PTY) Ltd.
No. 17 N12 Airport Industrial Park,
Dr. Vosloo Road, Barletts, Boksburg,
Johannesburg
Tel: (27) 11 894 3570
Fax: (27) 11 894 3501
Email: sales@jkc.co.za

**John King Chains
(Central Europe)**
ul. Grunwaldzka 182
85-401 Bydgoszcz, Poland
Tel/Fax: (48) 52 349 08 97
Mobile (48) 600 871 077
Email: aw@johnkingchains.com

John King USA Inc.
200 Catherine Street, Unit 7, Box 8,
East Peoria, USA IL 61611
Tel: (1) 309 698 9250
Fax: (1) 309 698 9259
Email: sales@johnkingchains.com

Cadenas John King Ltda.
Panamericana 5 Sur Km. 34
Parcela 13 – Lote C
Buin – Santiago, Chile
Fonos: (56) 2517 7313
Email: manuel@johnkingchains.com



REG NO: FM77342

www.johnkingchains.com